

The above figure shows a prediction of the total SPL (sound pressure level) map of the room with the chosen acoustic treatment installed. Note the smooth and even coverage of the system. Without EASE all anyone could do is spend a lot of money and hope they made a good guess.

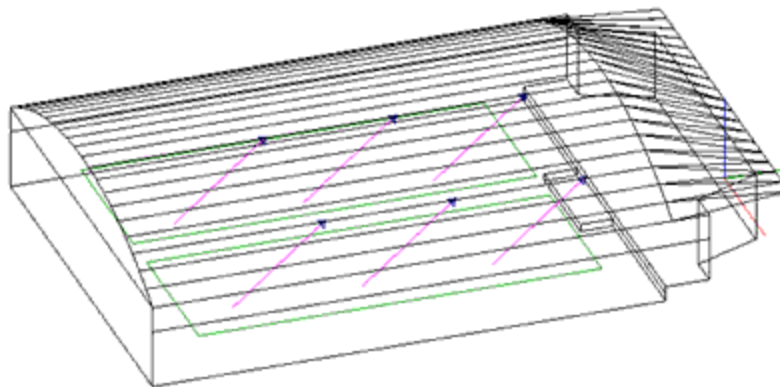

The above figure shows another example, that of rehabilitating an old manufacturing space into a new space for use as a church. Again, acoustic engineers started by building the room in the computer. EASE enabled the acoustic engineers to recommend, with certainty, because of the low height to length ratio, that a time delayed distributed sound system was the only way to provide proper and even coverage for the entire room. The standard single cluster at the front, proposed by the contractor would not have worked. EASE kept the client from spending thousands of dollars on a solution that would not work.